

1. This should not be any cost or any...
 2. "South 24 Parganas Zilla Parishad" will not be liable if any dispute arises of the...
 * The mention is valid for 3 years from date of execution
 * Information required by the applicant to this end are -
 * Construction of structural work up to ground floor.
 * No retention of a plot or to be used as a shed or for any other purpose.
 * The construction should be in accordance with the U.C. Code of Building Regulation and the bye-laws of the concerned authority.
 * Construction of high voltage water supply should be done by the applicant.
 * Any structure of the plot should be in accordance with the bye-laws.

Approved by
 South 24 Parganas
 South 24 Parg. Z.P.
 Hobbies
 South 24 Parg. Z.P.

- NOTES:**
- ALL DIMENSIONS ARE IN MM UNLESS IT IS MENTIONED.
 - FIRE-FIGHTING / SAFETY PROVISIONS WILL BE AS PER RELEVANT NBC PROVISIONS.
 - COVERING SLAB OF RESERVOIRS, FIRE TENDER PATH SHALL BE STRUCTURALLY SAFE FOR TAKING LOAD OF HEAVY VEHICLES LIKE FIRE TENDER.
 - ALL BUILDING WILL BE DESIGNED (STRUCTURES) AS PER RELEVANT I.S. CODES FOR EARTHQUAKE RESISTANCE.
 - PLEASE NOTE THAT THE DIMENSIONS IN THE DRAWINGS ARE TO BE READ, NOT MEASURED.

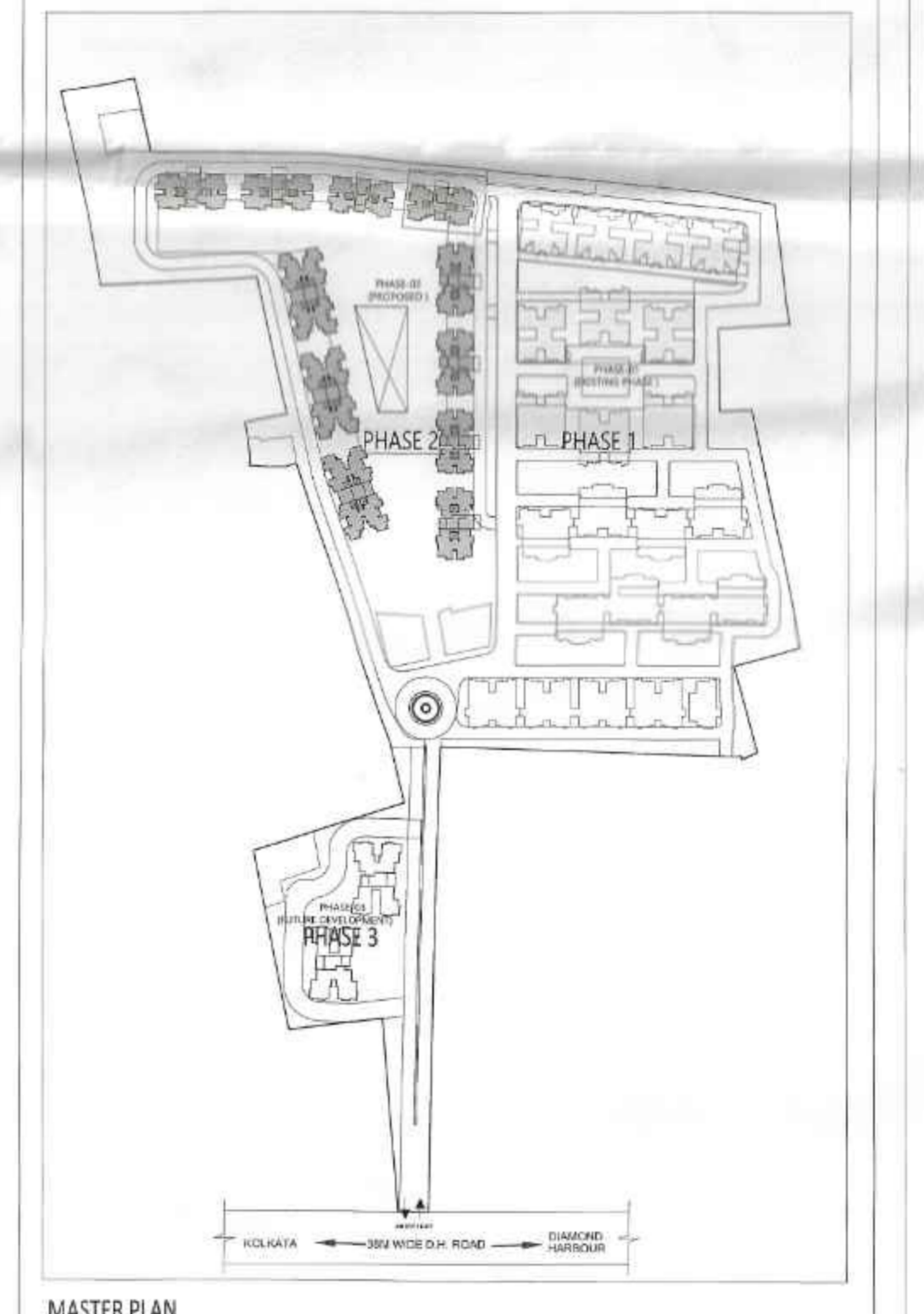

DTC PROJECTS PVT. LTD.
 Authorised Signatory
 SIGNATURE OF OWNER & SEAL
 DTC PROJECTS PVT. LTD.
 ADDRESS : 1 N S ROAD, KOLKATA-700001

WE DO HEREBY CERTIFY THAT THE FOUNDATION AND SUPERSTRUCTURE OF THE BUILDING PROPOSED FOR CONSTRUCTION ON THIS PREMISES HAVE BEEN SO DESIGNED BY ME/US WILL MAKE SUCH FOUNDATION AND SUPERSTRUCTURE SAFE IN ALL RESPECT INCLUDING THE CONSIDERATION OF BEARING CAPACITY AND SETTLEMENT OF SOIL ETC.

Signature of Engineer
 GEO TECHNICAL ENGINEER
 ADDRESS :

THE STRUCTURAL DESIGN AND DRAWINGS OF BOTH FOUNDATION & SUPERSTRUCTURE OF THE BUILDING HAS BEEN MADE BY ME CONSIDERING ALL POSSIBLE LOADS INCLUDING THE SEISMIC LOAD AS PER THE NATIONAL BUILDING CODE OF INDIA AND CERTIFIED THAT IT IS SAFE AND STABLE IN ALL RESPECTS.

SIGNATURE OF STRUCTURAL ENGINEER & SEAL
 CIVIL AND STRUCTURAL CONSULTANT:
 M.N Consultants (Pvt) Ltd.
 ISO 9001:2008 CERTIFIED
 M.N.C. HOUSE
 1516, Rajdanga Main Road,
 Kolkata-700 107.
 Ph no.-(033)4016-6700
 FAX NO. 2441-8083
 E-MAIL:mnancongs2008@gmail.com

THE PLOT HAS BEEN INSPECTED BY ME AND ON THAT BASIS I DO CERTIFY WITH FULL RESPONSIBILITY THAT THE PROPOSED BUILDING PLAN HAS BEEN DRAWN AS PER PROVISION OF BENGAL MUNICIPAL BUILDING RULE AS AMENDED FROM TIME TO TIME.

SIGNATURE OF ARCHITECT & SEAL
 Ar. KETAN SUNIL HINGANIKAR | CA2006/3736
 ADDRESS : N 85B, Panchsheel Park, New Delhi 110017, India

PROJECT NAME: SOUTHERN HEIGHTS
DTC
 COMMIT DELIVER GROW
 REVISED PLAN OF PROPOSED BY G+2P+17 RESIDENTIAL COMPLEX, DTC SOUTHERN HEIGHTS AT JOKA DIAMOND HARBOUR ROAD P.O. - JOKA P.S.-BISHNUPUR MOUZA - DOULATPUR BLOCK-BISHNUPUR-I.L. NO. - 79 DAG NO -11, 12, 13, 16, 17, 18, 19, 21, 24, 25, 26, 51, 52, 53, 54, 55, 56, 57, 58, 67, 87, 88, 89, 96, 97, 98, 99 MOUZA DALUATPUR, JI No-79 UNDER KULERDARI GRAM PANCHAYET DIST.-24 FARGANAS(S)
 ARCHITECT
 morphogenesis
 N 85B, Panchsheel park,
 New Delhi 110017, India
 TEL: 91 11 41828070 FAX: 91 11 26490351
 EMail: studio@morphogenesis.org
 SCALE: 1:200
 DATE: JUNE 2022
 TITLE
 TOWER B3 ELEVATION A & B SECTION AA' & B'
 ORIENTATION:
 N
 DWG NO. 35
 BUILDING HEIGHT:
 G+2P+17

GROUP HOUSING TOWERS A-D, ALL FLOORS					
TYPE	Width (MM)	Height (MM)	Lintel (MM)	Sill (MM)	
DOOR					
D1	Single Shutter Door	1000	2150	2150	0
D2	Single Shutter Door	900	2150	2150	0
D3	Single Shutter Door	800	2150	2150	0
D4	Single Shutter Door	1200	2150	2150	0
D5	Double Shutter Door	1500	2150	2150	0
D6	Sliding Door	2400	2150	2150	0
D7	Sliding Door	1800	2150	2150	0
D8	Sliding Door	1450	2150	2150	0
FIRE DOOR (2hrs. FIRE RATED)					
FD1	Single Shutter Door	1200	2150	2150	0
FD2	Double Shutter Door	1500	2150	2150	0
FD3	Single Shutter Door	1000	2150	2150	0
DOOR&WINDOW					
DW1	Single Shutter Window	800	2100	2100	0
DW2	Single Shutter Window	375	950	2150	1200
DW3	Single Shutter Window	800	2150	2150	0
DW4	Single Shutter Window	325	950	2150	1200
WINDOW					
W1	Double Shutter Window	900	1850	2150	300
W2	Single Shutter Window	600	1500	2150	650
W3	Triple Shutter Window	1800	1850	2150	300
W4	Triple Shutter Window	1500	1850	2150	300
W5	Double Shutter Window	1200	950	2150	1200
W6	Double Shutter Window	1200	1850	2150	300
W7	Top Hung Window	600	950	2150	1200
W8	Double Shutter Window	1350	1850	2150	300
W9	Fixed Window	600	1250	2150	900
W10	Louvered Window	900	1250	2150	900
W11	Louvered Window	1200	1250	2150	900
W12	Louvered Window	450	1250	2150	900
W13	Louvered Window	300	1250	2150	900
W14	Double Shutter Window	1200	1850	2150	300
W15	Double Shutter Window	1125	1850	2150	300
ROLLING SHUTTER					
RS1		2000	2150	2150	0

NOTE: All Heights, Sill and Lintel are from Finished Floor Level.
 All openings mentioned are Civil Openings.

